

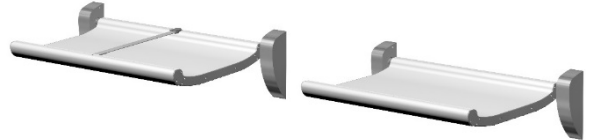

Safety Baby changing station 659/660

Wall mounted
Extremely strong, timeless design
2-year warranty



DAN DRYER baby changing table available with or without safety belt. The table is made of durable and vandal proof materials to ensure it stands the heavy and frequent usage in public areas. It has a unique carrying capacity of up to 400 kg.

Application

This wall-mounted baby changing station is exceptionally strong and thus ideal for public and commercial toilet facilities and it can withstand the rough treatment public toilet equipment is often subjected to.

References

Offices and administration, shopping centres, restaurants, hotels, airports, public swimming pools, schools, public institutions and cultural centres.

Technical data

	DAN DRYER Prod. No.: 659, 660 Safety Baby Changing Station
Type	
Width	967 mm
Width (excl. mountings)	798 mm
Depth (folded up)	100 mm
Depth (folded down)	626 mm
Height (folded up)	782 mm
Height (folded down)	269 mm
Material	Aluminium and brushed stainless steel
Load capacity	400 kg
Recommended working height	750 mm (from floor to lower edge of mountings)
Force required to open	~40 N; to close: ~25 N
Net weight	17.1 kg

Standard colour

Prod. No. 659: RAL 9012, white, gloss 80.
 Prod. No. 660: RAL 9012, white, gloss 80.

Variants

Also available in all RAL colours.

Materials

Changing surface in aluminium profile.
 Wall mountings and end flanges: brushed
 stainless steel

Installation

Wall mounting. Installation height from floor
 to lower edge of mountings: approx. 750 mm

Function

A gas spring in each wall mounting ensures
 easy opening and closing of the baby
 changing table.

Tender text

DAN DRYER safety baby changing station in aluminium and brushed stainless steel. Force required to open <40 N. Force required to close <25 N. Load capacity: 400 kg. Net weight: 17.1 kg.

W 967, D 100 folded up / 626 mm folded down, H 782 mm
 folded up / 269 mm folded down.