

Range 480

DESIGN

HEWI, Bad Arolsen

MATERIAL AND SURFACES

Stainless steel satin finished, chrome-plated, powder-coated in 3 colours or PVD coated in brushed and glossy nuances with inserts made of satin crystal glass.

ACCESSORIES

Product range	12
Basin area	15 – 19
Toilet area	19 – 21
Shower and bath area	22 – 23



HEWI SURFACES

■ ...40 chrome (Chr)

■ ...XA stainless steel, satin finished

■ ...60 DX powder-coated matt white (RAL 9003)

■ ...60 SC powder-coated matt dark grey pearl mica

■ ...60 DC powder-coated matt black (RAL 9005)

Special colours see separate document PUSOFASANINT

ACCESSORIES



Glass tumbler with holder
480.04.000... page 15

■ Holder
□ Tumbler



Soap or disinfectant dispenser with holder
480.06.00... page 15

■ Holder
□ Tumbler



Shower basket
480.03.001... page 23

■



Shelf
480.03.000... | 600 mm page 16

■

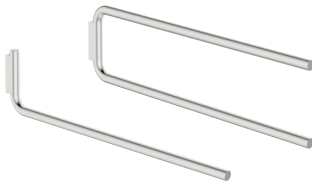

Towel rail
480.09.000... page 17
480.09.001... page 17

■



Towel ring
480.09.002... page 17

■



Hook | Double hook
480.90.000... page 18
480.90.001... page 18

■



Hook strip
480.90.002... page 19

■



Toilet roll holder
480.21.000... page 19

■



Toilet roll holder with lid
480.21.001... page 19

■



Toilet roll holder with shelf
480.21.002... page 20

■



Toilet brush unit | Toilet brush
480.20.000... page 21

■



Spare roll holder, double
480.21.004... page 21

■



Rail with shower head holder
480.33M000... | 600 mm page 23
480.33M001... | 900 mm page 23
480.33M002... | 1100 mm page 23

■

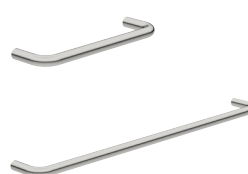

Support rail | Towel rail
480.36.00... page 22
480.30.00... page 18, 22

■



Side trolley
950.74.00060 page 16

■ Frame
■ Shelves

HEWI PVD COATING*

- ...70 CK brass glossy
- ...70 LP brass brushed
- ...70 WR nickel brushed
- ...70 EC black chrome glossy

HEWI INSERTS

- satin crystal glass

Product range | **Range 480**

Range 480

MATCHING PRODUCTS

Range 480 can be supplemented with the following products.



Hinged support rail Mono, Design A
900.50.1... | 600 mm page 230
900.50.4... | mobile page 236

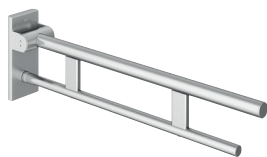

Hinged support rail Duo, Design A
900.50... from page 230
900.50.4... | mobile from page 236



Support rail
900.36.0... from page 250



L-shaped support rail | with toilet roll holder
900.22.3... from page 252

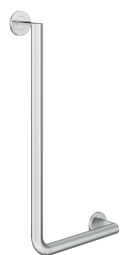

L-shaped support rail | with toilet roll holder
900.22.1... from page 254



Support grab rail
900.35.1... from page 258



Rail with shower head holder
900.33.0... from page 260



L-shaped support rail with shower head holder
900.33.2... from page 262



Shower curtain rail
900.34.400... from page 224



Hinged seat
950.51.20... page 488



Shower stool | Bath chair
950.51.3... from page 485



Universal products from page 653



Fittings from page 529



Washbasins from page 549



Mirrors from page 601



Dispenser products from page 617

*PVD coating: In addition to the 4 standard colours, you will also find 8 further special colours on page 768

Range 480 Accessories



Item Number

Dimensions in mm / Specification



■ ■ ■ ■ ■ ■ ■ ■ Holder
 ■ Tumbler

480.04.000XA
 480.04.00040
 480.04.00060
 480.04.00070

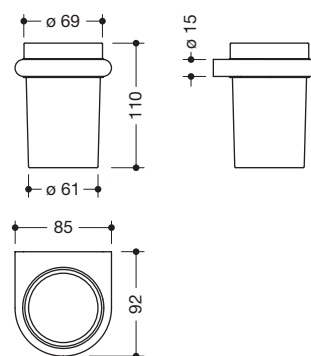
**HEWI Glass tumbler with holder**

- ring shaped wall holder made of high-quality stainless steel
- with protective ring made of synthetic material for a secure, defined position and to protect the glass insert from damage
- cylindrical tumbler made of high-quality, satin crystal glass, \varnothing 69 mm
- for wall mounting, concealed fixing
- 85 mm wide, 110 mm high and 92 mm deep
- including non-corrosive HEWI fixing material
- satin finished
- chrome-plated
- powder-coated in HEWI colours DX (matt white), SC (matt dark grey pearl mica) and DC (matt black)
- PVD coated



■ ■ ■ ■ ■ ■ ■ ■ Holder
 ■ ■ ■ ■ Pump head
 ■ Soap dispenser

480.06.002XA
 480.06.00240
 480.06.00260
 480.06.00270
 480.06.00370

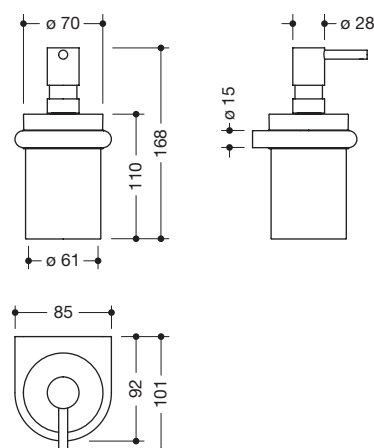
**HEWI Soap or disinfectant dispenser with holder**

- to be filled with standard liquid soap, disinfectants and gels
- ring shaped wall holder made of high-quality stainless steel
- with protective ring made of synthetic material for a secure, defined position and to protect the glass insert from damage
- soap dispenser made of high-quality, satin crystal glass
- capacity ca. 200 ml
- for wall mounting, concealed fixing
- 85 mm wide, 168 mm high and 92 mm deep
- including non-corrosive HEWI fixing material
- holder and pump head satin finished
- holder and pump head chrome-plated
- holder powder-coated in HEWI colours DX (matt white) with pump head in matt white or DC (matt black) and SC (matt dark grey pearl mica) with pump head in matt black
- PVD coated, with white pump head
- PVD coated, with black pump head

HEWI Surfaces

■ ■ ■ ■ ■ ■ ■ ■ ... DX matt white
 XA Chr Glass ■ ■ ■ ■ ■ ■ ■ ■ ... SC matt dark grey pearl mica
 ■ ■ ■ ■ ■ ■ ■ ■ ... DC matt black

HEWI PVD coating

■ ■ ■ ■ ■ ■ ■ ■ ...70 CK brass glossy
 ■ ■ ■ ■ ■ ■ ■ ■ ...70 LP brass brushed
 ■ ■ ■ ■ ■ ■ ■ ■ ...70 WR nickel brushed
 ■ ■ ■ ■ ■ ■ ■ ■ ...70 EC black chrome glossy

Detailed information about the spare parts can be found here:
www.hewi.com/en/spare-parts



480.03.000XA

480,03,00040

480.03.00060

480.03.00070

☐ ☐ ☐ ☐ ☐ ☐ ☐ ☐ ☐ ☐ Frame
☐ Shelf plate

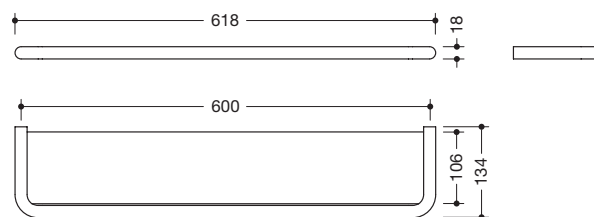

HEWI Shelf

- shelf with all-round edge and fixed glass plate
 - made of high-quality stainless steel tube \varnothing 18 mm
 - shelf plate made of glass (4 mm), matt sandblasted underside
 - for wall mounting, concealed fixing
 - 618 mm wide, 134 mm deep, c to c 600 mm
 - not suitable for use in the shower
 - including non-corrosive HEWI fixing material
-
- satin finished
 - chrome-plated
 - powder-coated in HEWI colours DX (matt white), SC (matt dark grey pearl mica) and DC (matt black)
 - PVD coated



950.74.00060



 Frame
 Shelves

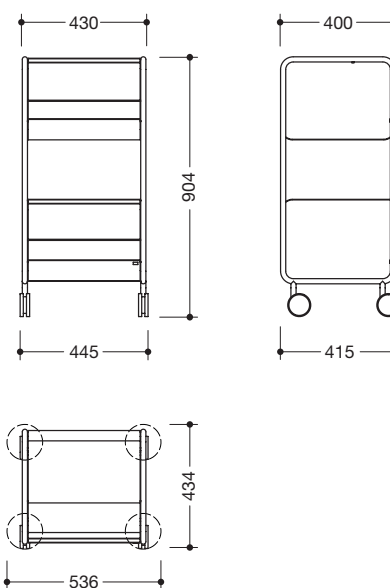



HEWI Side trolley

- single unit in shelf form with castors
- flexible and cross-range product for bathroom and adjoining living area
- 3 shelves, 2 of which have a back panel
- 430 mm wide, 904 mm high and 400 mm deep
- frame made of metal, chrome-plated
- with 4 chrome-plated castors for flexible use, 2 of which can be locked
- shelves made of metal, high-quality powder-coated
- available in colour combination DC (frame, shelves and castors matt black), VR (frame and castors chrome, shelf surfaces high-gloss white) or JK (frame and castors chrome, shelf surfaces matt black)

Please advise colour combination when ordering.

HEWI Powder coating | Material combinations

-  ...60 **VR** chrome | high-gloss white
 ...60 **JK** chrome | matt black
 ...60 **DC** matt black

Detailed information about the spare parts can be found here:
www.hewi.com/en/spare-parts

Item Number

Dimensions in mm / Specification

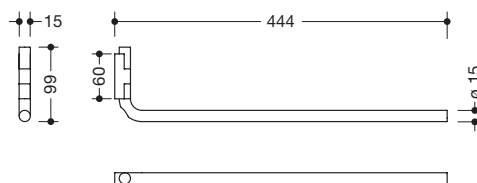

480.09.000XA
480.09.00040
480.09.00060
480.09.00070

**HEWI Towel rail**

- the arm can be swivelled sideways
- made of high-quality stainless steel
- 444 mm long, 99 mm high, arm \varnothing 15 mm
- for wall mounting, concealed fixing
- including non-corrosive HEWI fixing material
- satin finished
- chrome-plated
- powder-coated in HEWI colours DX (matt white), SC (matt dark grey pearl mica) and DC (matt black)
- PVD coated

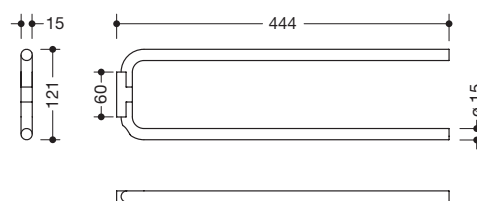

480.09.001XA
480.09.00140
480.09.00160
480.09.00170

**HEWI Towel rail**

- with two cylindrical arms arranged above each other
- the arms can be swivelled sideways independently of each other
- made of high-quality stainless steel
- 444 mm long, 121 mm high, arms \varnothing 15 mm
- for wall mounting, concealed fixing
- including non-corrosive HEWI fixing material
- satin finished
- chrome-plated
- powder-coated in HEWI colours DX (matt white), SC (matt dark grey pearl mica) and DC (matt black)
- PVD coated

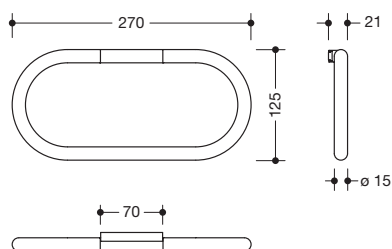

480.09.002XA
480.09.00240
480.09.00260
480.09.00270

**HEWI Towel ring**

- the ring can be swivelled
- made of high-quality stainless steel
- 270 mm wide, 125 mm high, \varnothing 15 mm
- for wall mounting, concealed fixing
- including non-corrosive HEWI fixing material
- satin finished
- chrome-plated
- powder-coated in HEWI colours DX (matt white), SC (matt dark grey pearl mica) and DC (matt black)
- PVD coated

HEWI Surfaces

... **DX** matt white
 XA Chr Glass ... **SC** matt dark grey pearl mica
 ... **DC** matt black

HEWI PVD coating

...**70 CK** brass glossy
 ...**70 LP** brass brushed
 ...**70 WR** nickel brushed
 ...**70 EC** black chrome glossy



480.30.000XA
480.30.00040
480.30.00060
480.30.00070

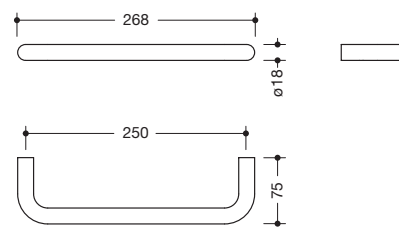

HEWI Towel rail

- made of high-quality stainless steel
- c to c 250 mm, 75 mm deep, ø 18 mm
- for wall mounting, concealed fixing
- including non-corrosive HEWI fixing material
- satin finished
- chrome-plated
- powder-coated in HEWI colours DX (matt white), SC (matt dark grey pearl mica) and DC (matt black)
- PVD coated



480.90.000XA
480.90.00040
480.90.00060
480.90.00070

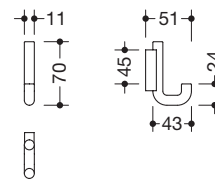

HEWI Single hook

- made of high-quality stainless steel
- 11 mm wide, 70 mm high, 51 mm deep, ø 11 mm
- for wall mounting, concealed fixing
- including non-corrosive HEWI fixing material
- satin finished
- chrome-plated
- powder-coated in HEWI colours DX (matt white), SC (matt dark grey pearl mica) and DC (matt black)
- PVD coated



480.90.001XA
480.90.00140
480.90.00160
480.90.00170

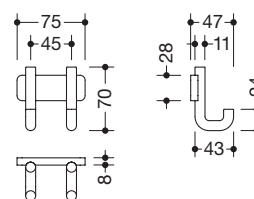

HEWI Double hook

- made of high-quality stainless steel
- 75 mm wide, 70 mm high, 47 mm deep, ø 11 mm
- for wall mounting, concealed fixing
- including non-corrosive HEWI fixing material
- satin finished
- chrome-plated
- powder-coated in HEWI colours DX (matt white), SC (matt dark grey pearl mica) and DC (matt black)
- PVD coated

Item Number

Dimensions in mm / Specification



480.90.002XA

480.90.00240

480.90.00260

480.90.00270

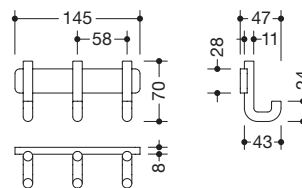
**HEWI Hook strip**

- made of high-quality stainless steel
- 145 mm wide, 70 mm high, 47 mm deep, ø 11 mm
- for wall mounting, concealed fixing
- including non-corrosive HEWI fixing material
- satin finished
- chrome-plated
- powder-coated in HEWI colours DX (matt white), SC (matt dark grey pearl mica) and DC (matt black)
- PVD coated



480.21.000XA

480.21.00040

480.21.00060

480.21.00070

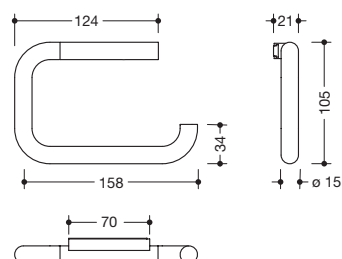
**HEWI Toilet roll holder**

- hinged, made of high-quality stainless steel
- 158 mm wide, 105 mm high, ø 15 mm
- for wall mounting, concealed fixing
- including non-corrosive HEWI fixing material
- satin finished
- chrome-plated
- powder-coated in HEWI colours DX (matt white), SC (matt dark grey pearl mica) and DC (matt black)
- PVD coated



480.21.001XA

480.21.00140

480.21.00160

480.21.00170

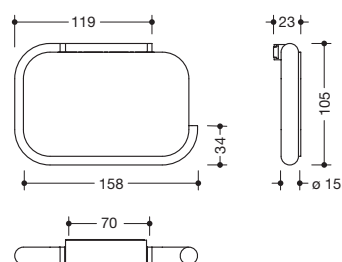
**HEWI Toilet roll holder with lid**

- hinged, made of high-quality stainless steel
- 158 mm wide, 105 mm high, ø 15 mm
- for wall mounting, concealed fixing
- including non-corrosive HEWI fixing material
- satin finished
- chrome-plated
- powder-coated in HEWI colours DX (matt white), SC (matt dark grey pearl mica) and DC (matt black)
- PVD coated

HEWI Surfaces

- ... DX matt white
- ... SC matt dark grey pearl mica
- ... DC matt black

HEWI PVD coating

- ...70 CK brass glossy
- ...70 LP brass brushed
- ...70 WR nickel brushed
- ...70 EC black chrome glossy

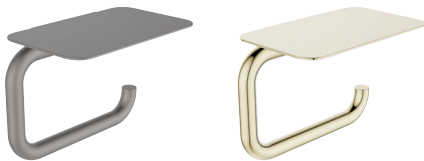

480.21.002XA

480.21.00240

480.21.00260

480.21.00270

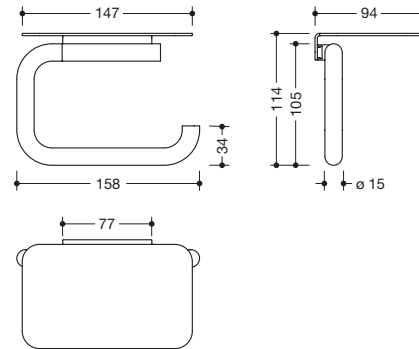

HEWI Toilet roll holder with shelf

- hinged, made of high-quality stainless steel
- 158 mm wide, 114 mm high, ø 15 mm
- shelf 147 mm wide, 94 mm deep
- for wall mounting, concealed fixing
- including non-corrosive HEWI fixing material
- satin finished
- chrome-plated
- powder-coated in HEWI colours DX (matt white), SC (matt dark grey pearl mica) and DC (matt black)
- PVD coated

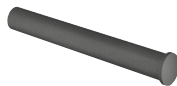

162.21.300XA

162.21.30040

162.21.30060

162.21.30070

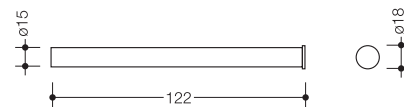

HEWI Spare roll holder

- cylindrical holder made of stainless steel
- 122 mm long, ø 15 mm
- for wall mounting, concealed fixing
- including non-corrosive HEWI fixing material
- satin finished
- chrome-plated
- powder-coated in HEWI colours DX (matt white), SC (matt dark grey pearl mica) and DC (matt black)
- PVD coated

Detailed information about the spare parts can be found here:
www.hewi.com/en/spare-parts

Item Number

Dimensions in mm / Specification

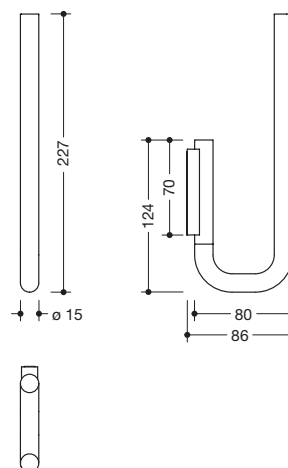

480.21.004XA
480.21.00440
480.21.00460
480.21.00470

**HEWI Spare roll holder, double**

- for holding two toilet rolls, can be swivelled sideways to the wall
- 227 mm high, 86 mm deep, ø 15 mm
- for wall mounting, concealed fixing
- including non-corrosive HEWI fixing material
- satin finished
- chrome-plated
- powder-coated in HEWI colours DX (matt white), SC (matt dark grey pearl mica) and DC (matt black)
- PVD coated

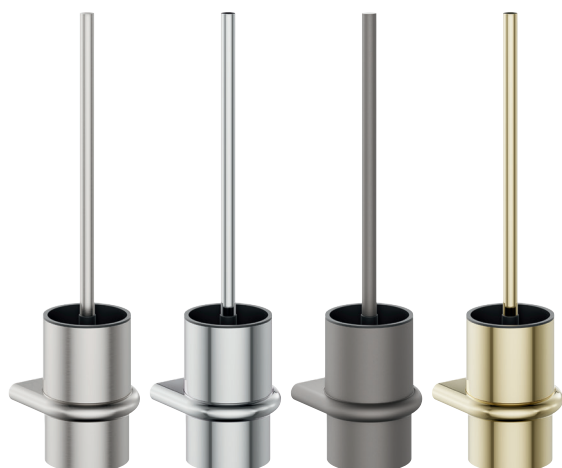

480.20.000XA
480.20.00040
480.20.00060
480.20.00070

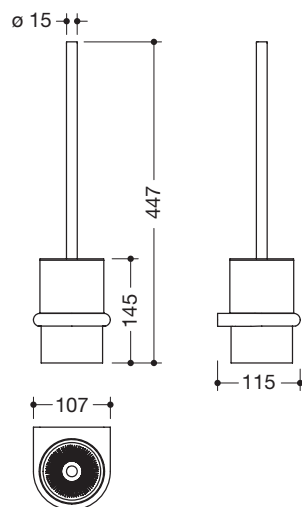
**HEWI Toilet brush unit**

- consisting of ring-shaped holder, cylindrical toilet brush container and toilet brush
- brush head can be replaced due to bayonet fixing
- black inner container can be removed for cleaning
- made of high-quality stainless steel
- 107 mm wide, 447 mm high, 115 mm deep
- for wall mounting, concealed fixing
- including non-corrosive HEWI fixing material
- satin finished
- chrome-plated
- powder-coated in HEWI colours DX (matt white), SC (matt dark grey pearl mica) and DC (matt black)
- PVD coated

HEWI Surfaces

- XA Chr
 ... DX matt white
 ... SC matt dark grey pearl mica
 ... DC matt black

HEWI PVD coating

- ...70 CK brass glossy
 ...70 LP brass brushed
 ...70 WR nickel brushed
 ...70 EC black chrome glossy

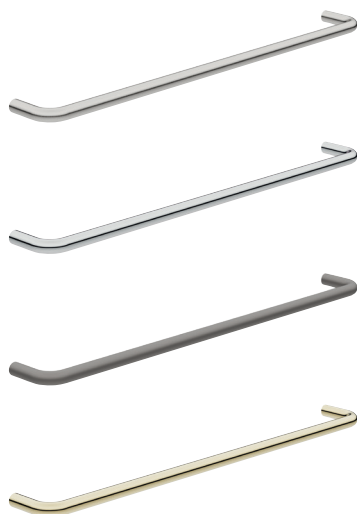

480.30...XA
480.30...40
480.30...60

480.30...70

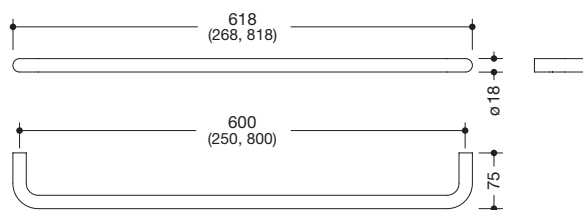

HEWI Towel rail

- made of high-quality stainless steel
- 75 mm deep, ø 18 mm
- for wall mounting, concealed fixing
- including non-corrosive HEWI fixing material
- satin finished
- chrome-plated
- powder-coated in HEWI colours DX (matt white), SC (matt dark grey pearl mica) and DC (matt black)
- PVD coated

A1 (in mm)	satin finished	chrome-plated	powder-coated	PVD coated
250	480.30.000XA	480.30.00040	480.30.00060	480.30.00070
600	480.30.001XA	480.30.00140	480.30.00160	480.30.00170
800	480.30.002XA	480.30.00240	480.30.00260	480.30.00270



480.36...XA
480.36...40
480.36...60

480.36...70

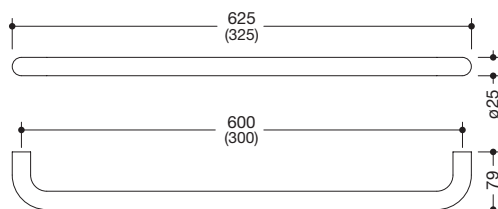

HEWI Support rail

- made of high-quality stainless steel
- 79 mm deep, rail ø 25 mm, tube thickness 2 mm
- for wall mounting, concealed fixing
- incl. non-corrosive and tested HEWI fixing material for wall mounting
- additional sealing of the drilling points possible with sealing tape (included in delivery)
- satin finished
- chrome-plated
- powder-coated in HEWI colours DX (matt white), SC (matt dark grey pearl mica) and DC (matt black)
- PVD coated

A1 (in mm)	satin finished	chrome-plated	powder-coated	PVD coated
300	480.36.000XA	480.36.00040	480.36.00060	480.36.00070
600	480.36.001XA	480.36.00140	480.36.00160	480.36.00170



HEWI Surfaces

- ... DX matt white
- XA Chr ■ ... SC matt dark grey pearl mica
- ... DC matt black

HEWI PVD coating

- ...70 CK brass glossy
- ...70 LP brass brushed
- ...70 WR nickel brushed
- ...70 EC black chrome glossy

Item Number

Dimensions in mm / Specification

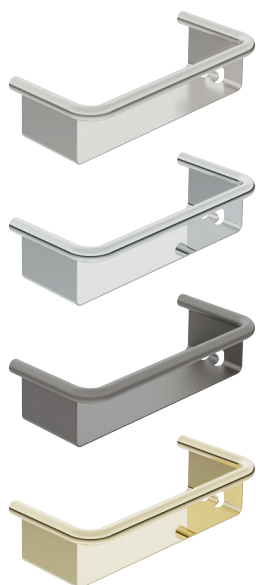
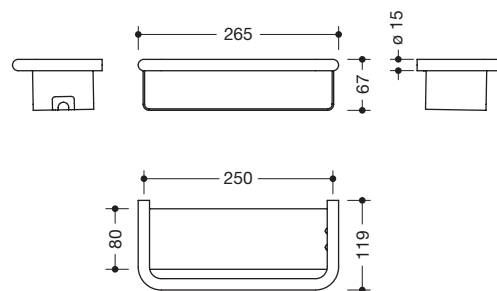
**480.03.001XA****480.03.00140****480.03.00160****480.03.00170****HEWI Shower basket**

- surface slightly inclined for water drainage
- made of high-quality stainless steel
- with integrated hook
- 265 mm wide, 67 mm high, 119 mm deep
- for wall mounting, concealed fixing
- including non-corrosive HEWI fixing material
- satin finished
- chrome-plated
- powder-coated in HEWI colours DX (matt white), SC (matt dark grey pearl mica) and DC (matt black)
- PVD coated

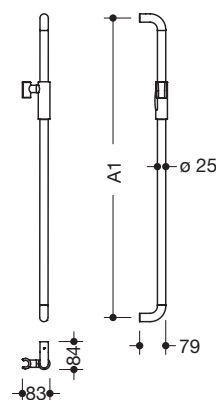
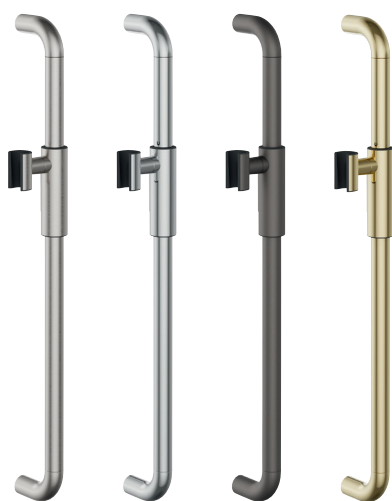
**HEWI Rail with magnetic shower head holder**

- rail \varnothing 25 mm, 79 mm deep, tube thickness 1,5 mm
- made of high-quality stainless steel
- with magnetic shower head holder made of high-quality stainless steel
- suitable for various manufacturers' shower heads
- simple and intuitive one-hand operation
- shower head holder infinitely adjustable, automatically fixed in place by magnets
- wear-free clamping mechanism
- conical holder on shower holder can be adjusted to any angle
- incl. non-corrosive and tested HEWI fixing material for wall mounting
- additional sealing of the drilling points possible with sealing tape (included in delivery)

A1 (in mm)	satin finished	chrome-plated	powder-coated	PVD coated
600	480.33M000XA	480.33M00040	480.33M00060	480.33M00070
900	480.33M001XA	480.33M00140	480.33M00160	480.33M00170
1100	480.33M002XA	480.33M00240	480.33M00260	480.33M00270

**HEWI Powder coating | Material combinations with synthetic material**

■ ...60 ER matt dark grey pearl mica | matt black synthetic material

■ ...60 CV matt black | matt black synthetic material

■ ...60 VH matt white | matt light grey synthetic material